

Type 52 Blowout Preventer

AXON's Type 52 Annular BOP is designed for safe well pressure control during drilling and workover operations. Ideal where space is a priority, this short, compact design has been proven and accepted for reliable operation. Its five main components (lower housing, upper housing, piston, adapter ring, and packing element) allow for easy maintenance and reliability.

Moreover, AXON's Type 52 packing element can close on all pipes, casing, wireline, coiled tubing, and more to its full working pressure. Stripping of pipe, tubing, and wireline through the packing element can also be accomplished at lower pressures.



SPECIFICATIONS

- Designed and manufactured to ISO 13533 (API 16A) for drill-through equipment
- Designed as standard to ISO 15156-1 (NACE MR-0175) for use in hydrogen sulfide environments
- Bore sizes: 4-1/16" to 21-1/4"
- Pressure Rating: 2,000 to 10,000
- Standard operation pressure of 1500 psi (10,34 Mpa)
- Normal configuration is flanged bottom (or clamp hub) connection and a studded top flange connection
- Hydraulic operation performed by connection to open and close (NPT) ports located on the body, which are connected to the control system
- Spherical inverted bowl in the upper housing causes steel inserts in the packing element to rotate inward to the well bore
- Replacement of the packing element is performed by removing nuts from stud bolting in the lower housing and lifting the upper housing upward

FEATURES / BENEFITS

- Steel inserts prevent extrusion of the rubber and feed inward to close on any pipe or tubular in the well bore
- Replaceable bearings are used in the operating system to prevent metal contact of moving parts
- Adapter ring located below the upper housing prevents contamination of the operating system during packing element replacement
- Wedged-cover upper housings are also available
- Available in all standard bore and pressure ratings
- Special rubber materials available for non-standard environments

Type 52 Annular Blowout Preventer

SPECIFICATIONS

Assembly Detail: Flange Bottom x Studded Top, Wedge Cover

Bore Size	11" 10M	13-5/8" 10M	13-5/8" 10M	16-3/4" 5M	18-3/4" 5M	21-1/4" 5M	21-1/4" 5M
Bottom Connection	11" 10M	13-5/8" 10M	13-5/8" 15M	16-3/4" 5M	18-3/4" 10M	21-1/4" 5M	21-1/4" 10M
A	57.00"	64.50"	64.50"	60.00"	66.25"	71.00"	71.00"
B	52.00"	58.88"	58.88"	55.88"	61.75"	66.13"	66.13"
C	53.00"	59.00"	59.00"	56.75"	64.62"	69.50"	69.50"
D	21.12"	23.00"	23.00"	23.68"	28.96"	32.20"	32.20"
E	6.00"	7.00"	7.00"	6.75"	7.00"	7.50"	7.50"
F	12.88"	14.56"	14.56"	14.25"	18.87"	20.19"	20.19"
G	20.25"	21.94"	21.94"	15.75"	18.38"	22.69"	22.69"
H	5.25"	5.25"	5.25"	5.25"	5.25"	5.25"	5.25"
J	1.50"	2.00"	2.00"	1.75"	2.00"	3.00"	3.00"
K	53.18"	58.50"	61.75"	52.31"	62.63"	66.23"	69.62"
L	9.68"	10.75"	13.75"	9.25"	13.63"	11.74"	15.12"
Approx. Weight	23,000 lbs	32,500 lbs	33,500 lbs	22,900 lbs	37,400 lbs	44,500 lbs	46,200 lbs
Volume	Opened	24.67 gal.	32.64 gal.	32.64 gal.	25.61 gal.	37.61 gal.	47.76 gal.
	Closed	30.58 gal.	40.16 gal.	40.16 gal.	33.26 gal.	48.16 gal.	61.37 gal.
Hyd. Conn.	Number	2	4	4	2	4	4
	Size	2" NPT	2" NPT	2" NPT	2" NPT	2" NPT	2" NPT

Diagram: Flange Bottom x Studded Top, Wedge Cover

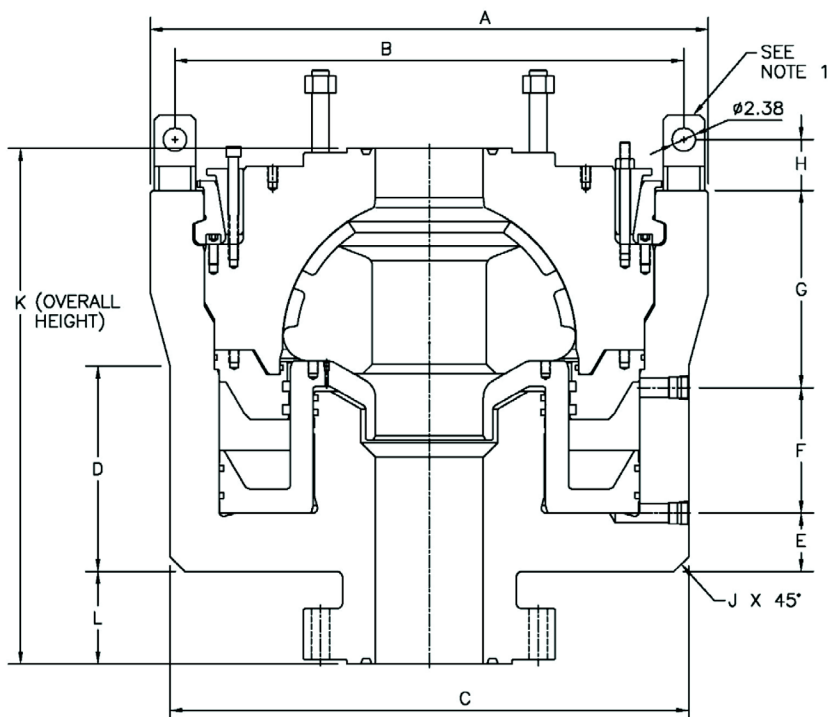

NOTE:

1. Upper body lift lugs, 4 places at 90°. Lift capacity 70,000 (31751 KG)/LUG.

Type 52 Annular Blowout Preventer

SPECIFICATIONS

Assembly Detail: Flange Bottom x Studded Top, Bolted Cover

Bore Size	4-1/16" 10M	7-1/16" 3M	7-1/16" 5M	7-1/16" 10M	7-1/16" 10M	11" 5M	11" 5M
Bottom Connection	4-1/16" 15M	7-1/16" 3M	7-1/16" 5M	7-1/16" 10M	7-1/16" 15M	11" 5M	11" 10M
A	11.43"	13.75"	13.75"	19.31"	19.31"	17.69"	17.69"
B	6.00"	8.75"	8.75"	11.13"	11.13"	12.62"	12.62"
C	16.00"	16.62"	18.38"	25.31"	26.19"	25.56"	26.68"
D	26.05"	29.12"	30.88"	42.38"	43.25"	41.50"	42.62"
E	23.00"	29.00"	29.00"	43.00"	43.00"	44.75"	44.75"
F	9,500 lbs	9,500 lbs	13,000 lbs	50,000 lbs	50,000 lbs	34,000 lbs	34,000 lbs
Approx. Weight	1,895 lbs	2,925 lbs	3,175 lbs	10,600 lbs	10,675 lbs	9,550 lbs	9,800 lbs
Hyd. Ports	3/4" NPT	1" NPT	1" NPT	1-1/4" NPT	1-1/4" NPT	1-1/4" NPT	1-1/4" NPT
Volume	Opened	1.95 gal.	3.43 gal.	3.21 gal.	13.95 gal.	13.95 gal.	14.60 gal.
	Closed	2.38 gal.	4.92 gal.	4.57 gal.	17.20 gal.	17.20 gal.	18.70 gal.

Bore Size	13-5/8" 3M	13-5/8" 5M LW	13-5/8" 5M	13-5/8" 5M	20-3/4" 3M	21-1/4" 2M	30" 1M
Bottom Connection	13-5/8" 3M	13-5/8" 5M	13-5/8" 5M	13-5/8" 10M	20-3/4" 3M	21-1/4" 2M	30" ASME 600
A	19.68"	19.56"	20.67"	20.62"	21.41"	21.06"	34.44"
B	10.88"	12.38"	12.00"	12.00"	14.16"	14.62"	17.50"
C	22.56"	24.25"	26.31"	30.38"	38.31"	28.12"	34.25"
D	40.74"	42.25"	44.98"	49.12"	48.44"	46.25"	65.69"
E	46.38"	46.50"	50.00"	50.00"	54.12"	49.00"	71.00"
F	34,000 lbs	50,000 lbs	50,000 lbs	50,000 lbs	50,000 lbs	50,000 lbs	50,000 lbs
Approx. Weight	9,100 lbs	10,000 lbs	13,650 lbs	14,200 lbs	14,600 lbs	10,850 lbs	28,750 lbs
Hyd. Ports	1-1/2" NPT	1-1/2" NPT	1-1/2" NPT	1-1/2" NPT	1-1/2" NPT	1-1/2" NPT	2" NPT
Volume	Opened	14.67 gal.	14.67 gal.	17.41 gal.	17.41 gal.	26.90 gal.	55.00 gal.
	Closed	23.50 gal.	23.50 gal.	23.58 gal.	23.58 gal.	43.40 gal.	122.00 gal.

Diagram: Flange Bottom x Studded Top, Bolted Cover

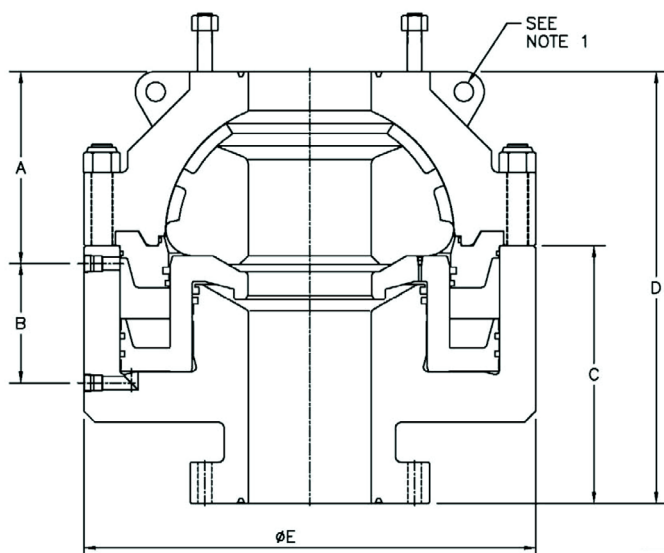

NOTE:

1. Upper body lift eyes, 2 places at 180°. Lift capacity "F" per lift eye.

Type 52 Blowout Preventer

AFTERMARKET SERVICES

Aftermarket is not an Afterthought™

AXON's focus is to provide you with high-quality products that perform, as well as ensure you receive continued customer satisfaction through our aftermarket training, repair, and servicing.

We are dedicated to providing you with an exceptional aftermarket experience in regards to both products and services. From immediate service on equipment at your operating site to skilled remanufacturing service, you can count on AXON to provide the quick response, superior know-how, and true sensitivity to your schedule. For instance, AXON Pressure Products provides 24/7 field service and a large inventory of the most requested parts to minimize downtime on your site. In addition, we can provide you with package solutions through our expansive product line within AXON's six product groups.



Locations

- | | | |
|---|--|---|
| ■ 8909 Jackrabbit Road
Houston, Texas 77095
281.855.3200 | ■ 596 South Hollywood Road
Houma, Louisiana 70360
985.872.3711 | ■ 2038 McAulty Road
Houston, Texas 77032
281.214.8558 |
| ■ 12616 N. Houston Rosslyn Road
Houston, Texas 77086
713.581.2515 | ■ 170 Alliance Court
Houma, Louisiana 70361
985.872.3711 | ■ 607 22 nd Avenue
Nisku, AB Canada T9E 7X7
780.955.2400 |
| ■ 12606 N. Houston Rosslyn Road
Houston, Texas 77038
713.581.2515 | ■ 2810 Washington Drive
Houston, Texas 77038
281.931.1400 | ■ 899 rue du Docteur Schaffner
62221 Noyelles sous Lens, France
+33.321.787.892 |

Additional Images

